

The information contained in this drawing is the sole property of CWS Coil Winding Specialist. Any reproduction in part or whole without written permission of CWS Coil Winding Specialist is prohibited.

REVISION HISTORY

REV	ECN	DESCRIPTION	BY	DATE	CHK	DATE
C		PRODUCTION RELEASE	TDK	12/07/04	JLAV	12/07/04
D		REVISED DIMENSION AS SAME AS K68XXXXX47-A01	KLC	4/4/08	RL	4/4/08
E		REVISED NOTE #7 & NOTE #8	KLC	7/17/08	RL	7/17/08

- 11 BUILD TO ROHS COMPLIANCE AND LEAD FREE
- 10 OR OVEN CURED AS REQUIRED  
DIP-VANISH WITH AQ43 OR EQUAL AND AIR DRY
- 9 THIS IS CRITICAL MAXIMUM DIMENSION
- 8 BOTTOM OF CORE TO START OF TINNING  
6.5±0.5 MM DIMENSION MEASURED FROM
- 7 TOP OF CORE TO START OF TINNING  
13.5 MM DIMENSION MEASURED FROM
- 6 USING A PERMANENT MARKING METHOD  
MARK PART NUMBER AND REVISION  
WRAP INDUCTOR WITH TAPE. (PER NOTE 2)

- 5 TO THE CORE  
MUST REST FLAT ON PCB. LEADS MUST BE TANGENT  
FLUSH WITH THE COIL EDGE. AS SHOWN (I.E. COIL  
REMOVE INSULATION AND TIN LEADS 7.0 MM MIN
- 4 SIDE OF CORE AND EVENLY SPACED, POLARITY NOTED  
WIND 4 TURNS, .072x .182 RECT. SINGLE LAYER ON EACH  
CONSTRUCTION:
- 3 TO INSURE INTEGRITY OF WINDING SEPARATION  
HI-POT TEST FOR INTERWINDING ISOLATION = 250VDC  
POWER LOSS = 5.2 W MAX @ 80A/COIL  
DCR = .4 MOHMS MAX./COIL  
L = 52 uH MIN / COIL, 70 uH NOM / COIL, 1 KHZ, 1Vrms  
SPECIFICATIONS @ 25°C:

- 2 APPROVED PART  
OUTER WRAP: 3M #11 OR #69 OR OTHER CWS  
WIRE: UL RECOGNIZED 200°C RATING MAGNET WIRE  
CWS BYTEMARK OR OTHER APPROVED PART  
CORE: COATED 6000 VOLT FERRITE TOROID, HIGH PERM MNZN
- 1 CLASS B (130°C) REQUIRED  
MATERIAL: UL RECOGNIZED 94V-0 FOR FLAMMABILITY

NOTES: UNLESS OTHERWISE SPECIFIED, READ FROM BOTTOM UP

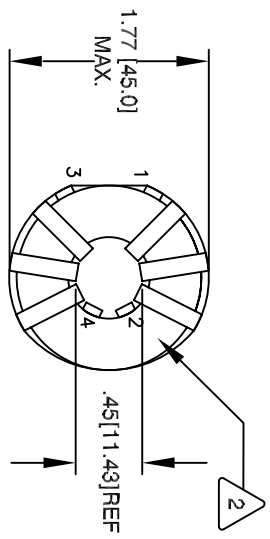
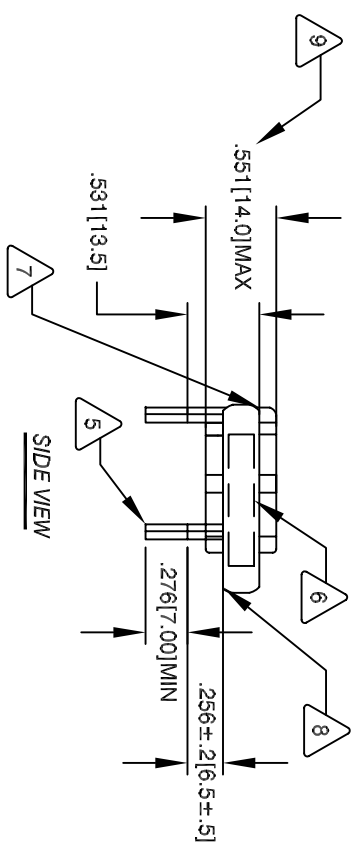

BOTTOM VIEW

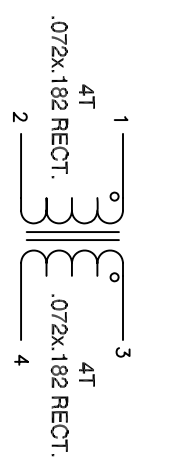

SCHEMATIC

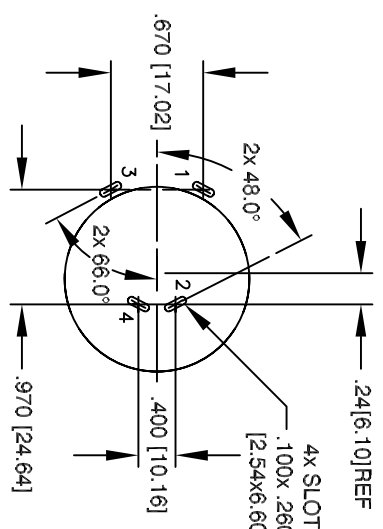

MOUNTING HOLES PATTERN

QTY	CODE IDENT	MFG. P/N	DESCRIPTION	ITEM NO.
			<b>PARTS LIST</b>	
	AUTOCAD			
	SOLIDWORKS			
	DRWING	DATE		
	TKK	12/07/04		
	DKXD	12/07/04		
	ENGR	KSJM	12/07/04	
	APPR	JLAV	12/07/04	
UNLESS OTHERWISE SPECIFIED				
DIMENSIONING AND TOLERANCE PER ANSI Y14.5M AND [MILLIMETERS]				
TOLERANCE INCHES:				
.XXX±E.O10 XX±E.020		±.0030		
.XXX±E.25X ±A±.51		±.0030		
ANGLE PROJECTION		DO NOT SCALE DRAWING		
TITLE:		Inductor Common Mode		
SIZE (DWG. NO.)		C-36A29-06		
SCALE		1=1		
SHEET		1 OF 1		

COILS COM, INC  
353 W Grove Ave  
Orange, CA 92865

CWS Coil Winding Specialist  
70uH 80A